

Learning Lab & Creation Lab Faqs

1. How long will construction last?

We predict that the new Learning Lab and Creation Station will be finished and open by spring 2026.

2. Where can you get technology help?

A learning lab staff member will be on hand to help you at our Reference desk. Additionally, you can call 419.521.3146 to speak to someone directly or email them at learning@mrcpl.org.

3. What will you see in the new spaces?

The learning lab will feature bold new colors and updated technology, including a new copy machine. The Creation Lab will feature machinery such as 3D printers, 3D pens, a Cricut®, an embroidery machine, and more!

4. Where can you go to study, if the construction is loud?

Unfortunately, we cannot control the noise level during construction. In the case that the noise is distracting, we do offer soundproof study pods and have available meeting rooms for use.

5. Will there still be classes while construction is going on? Can I still make 1-on-1 appointments?

Yes! Both these services will continue to be available. Classes will be held in other locations at the Main Library. Please check our events calendar, call the Lab staff at 419-521-3146 or enquire at the Reference Desk.

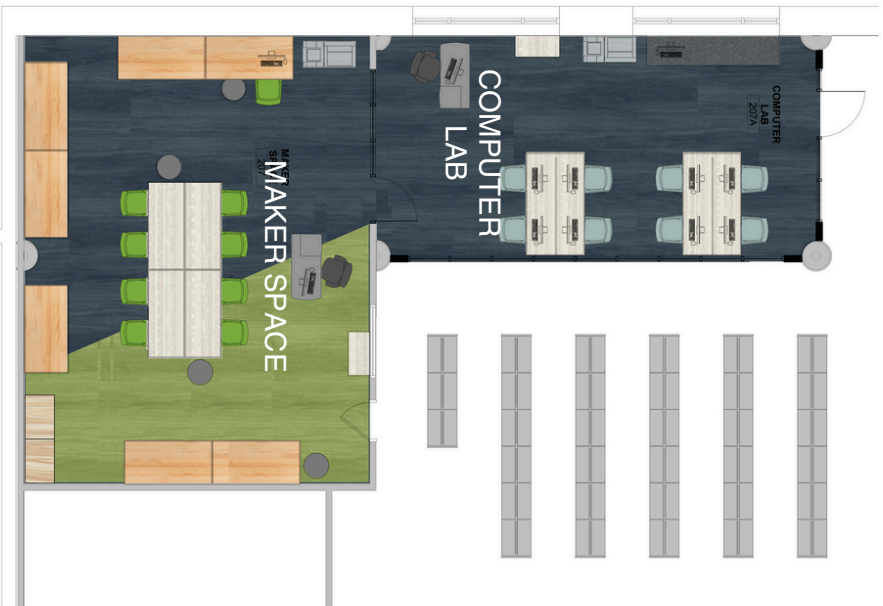

1
20
RENDERED FINISH PLAN
1/4" = 1'-0"

RENDERED FINISH PLAN
1/4" = 1'-0"
0 5 10 20

Mansfield Main Library
MAKER SPACE & COMPUTER LAB

HBM ARCHITECTS, LLC

01/25/2024

HBM ARCHITECTS
INTERIOR DESIGNERS